

**IKON**  
by Renegade



LEGENDARY RENEGADE LUXURY AND QUALITY

DESIGNED FOR <sup>YOUR</sup> LIFE



**THE MOST POWERFUL LUXURY COACH BUILT.**

IKON delivers sophisticated styling combined with attention to detail that comes with every Renegade motorhome. From the contemporary design and quality construction to the hand-crafted solid hardwood cabinetry, IKON delivers the features, comfort and durability that discriminating customers demand. Sumptuous Villa Ultraleather furniture, quartz countertops and heated porcelain tile floors are all standard, along with Samsung® 4K LED TV's, Bose® Home Theater Sound, and a luxurious ensemble of premium stainless steel appliances.



**A MASTERFUL BLEND OF COMFORT AND FUNCTIONALITY.**

The master suite features king size sleeping accommodations with tasteful and elegant decors accompanied by generous wardrobe and dresser storage. Premium entertainment systems include a Samsung® 4K LED TV and Bose® Solo home theater system neatly tucked into the handcrafted hardwood cabinetry. And you'll enjoy feeling pampered in the luxurious and inviting private master bath, with a gleaming porcelain tile shower with glass enclosure, spacious vanity and an infinitely adjustable LED vanity lighting system.



**Construction, Exterior, Automotive**

- Aluminum Framed High Gloss Laminate Walls
- Front Impact Area Anti Chip Paint Protection
- Frameless Thermopane Windows
- Full Length Roof Mounted Electric Awning
- Tag Hitch 30,000# Trailer Weight; 4,500# Tongue Weight
- 4-Point Hydraulic Leveling System
- Back-Up Camera with Monitor
- Outside Entertainment Center with 4K LED TV
- Power Entry Door and Baggage Door Locks
- Villa Heated/Massage Captain's Chairs

**Bath & Water Systems**

- 150 Gallons Fresh Holding Tank; (2) 75 Gallon Holding Tanks
- Black Tank Flush System
- Pressurized Fill and City Water Connection
- Pressurized Auxiliary Wash Hose
- Power Water Hose Reel
- Tile Shower with Decorative Accents

**Mechanical Systems**

- AquaHOT 600D Hydronic System
- (3) 15,000 BTU Completely Ducted Roof A/C with Water Drains
- 30' 50 AMP (Shore Line) Power Cord On Reel
- 12.5 KW Onan® Quiet Diesel with Switch in Living Quarters and Bedroom
- 2800 Watt Inverter with AGS
- (2) 8-D AGM Batteries

**Interior**

- 7'6" Interior Height (90")
- Hydraulic Operated Slide Outs
- Stacked Washer/Dryer
- Porcelain Tile Floor with Radiant Heat
- MCD Power Day/Night Shades
- Multiplex LED Lighting System
- Nickel Hardware Finishes
- Quartz Countertops

**Galley**

- Decorative Ceiling Treatment
- Villa Ultraleather Furniture
- High Gloss Hardwood Cabinetry
- 22 CU. FT. Stainless Residential Refrigerator
- 1.7 CU. FT. Convection Microwave
- 2 Burner Electric Cooktop
- 50" 4K LED TV with Remote (N/A On All FP)
- Bose® Home Theatre with Remote
- Blu Ray Player

**Bedroom**

- 40" 4K LED TV in Bedroom
- Bose® Soundbar and Blu-Ray Player
- Ortho/Rest Memory Mattress
- Bedspread and Pillow Shams

**Popular Options**

- Granite Tile Flooring
- Choice of Maple, Cherry, or Hickory Cabinets
- Global Positioning System (GPS)
- Dishwasher
- Outside Fridge/Freezer
- Stationary HD or In-Motion SD Satellite System

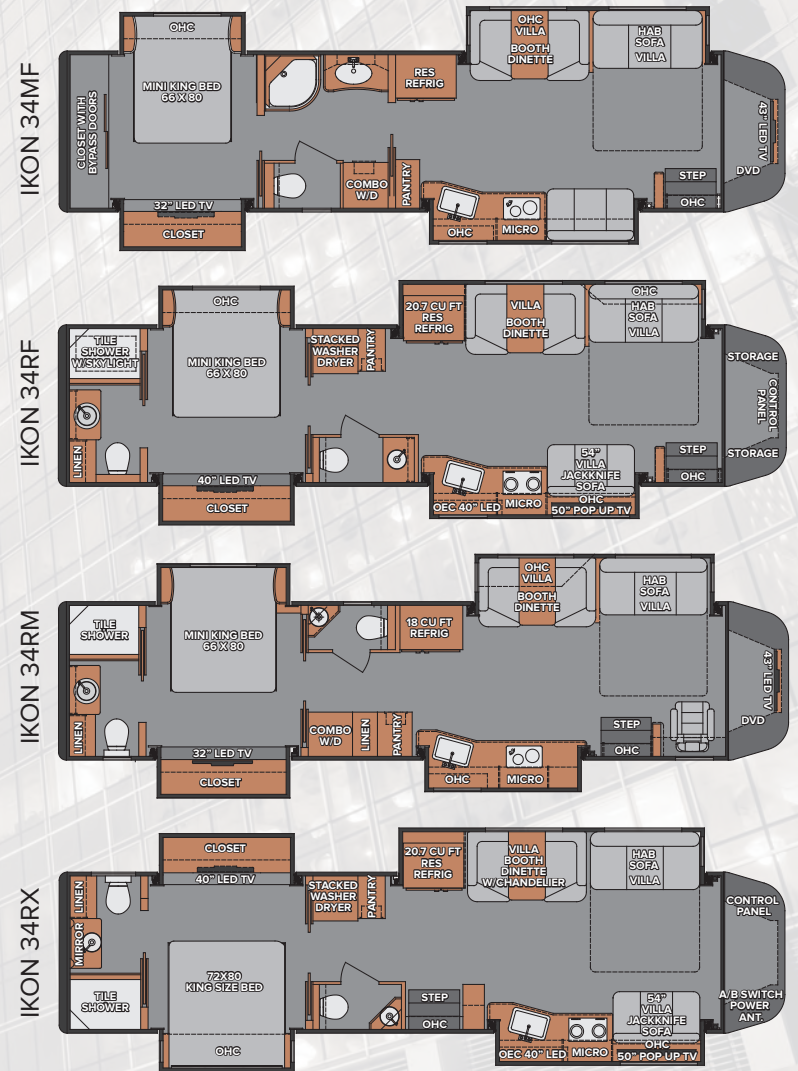

YOUR RENEGADE DEALER:

Due to continued product improvement and changes in suppliers, design, and production; equipment, colors, material specifications, prices and model availability are subject to change without notice. Some photography may show optional items. Kibbi manufacturers motorhomes and trailers of varying sizes which may or may not be legal in all states; it is the responsibility of the owner to determine the legal lengths in the state of operation.

